

new

# DZAO

FACTORY  
SPIRIT

MADE IN  
FRANCE

## SERIES 113M



### Minimalist aluminium casement window non thermal break

DZAO® is a range of traditional aluminium casement windows allowing minimalist frames without thermal break, which can integrate casement opening, tilt&turn, top or bottom hung... with a aluminium sightline of only 66,3 mm in lateral and 80,7 mm in central.

STRAIGHT  
Design

FACTORY  
SPIRIT

#### CONFIGURATIONS

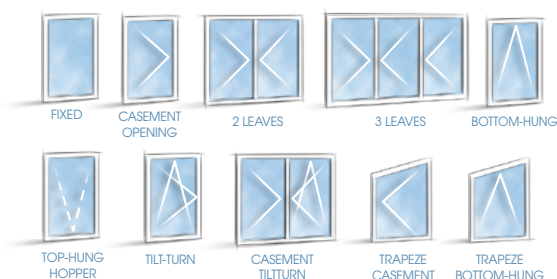

#### FACTORY SPIRIT® VERSION

FACTORY SPIRIT® Design: sleek, spare lines on all opening and fixed sections.

#### FRAME

**Tubular frame** 51mm wide with clip-on weatherdrip and a jamb liner for covering insulation available.

#### OPENING SECTION

**Tubular opening section** : straight edges inside and outside of 59,6 mm.

#### GLAZING

Single or insulated glazing from 8 to 12 mm, held by 2 EPDM gaskets and 1 clip-on glazing bead.

#### FEATURES

- Complete range
- All kinds of **frames** can be created
- Opening section of **59,6 mm**
- Effective **water deflector** on fixed frame
- Maximum Dimension up to : **W 2000 x H 2150 mm**
- **Hidden drainage** on opening section
- **Architraves** and weather-drips common to whole series
- Locking rod and handle **without base-plate** available
- **Invisible hinges**
- **Simplified gaskets** : time saving
- Available in all Profils Systèmes' exclusive colours : **Terra Cigala®, Profils Color®, Terre de Matières®**
- Colour shades guaranteed up to 25 years

#### RATINGS

##### Weather tightness :

Dimensions W1230 x H14800 mm / Results AEV : **A\*4 E\*9 V\*E24000C** casement window 1 leaf

Dimensions W1530 x H14800 mm / Results AEV : **A\*4 E\*9 V\*E24000B** casement window 2 leaves

#### ASSEMBLY

Fixed frame and opening section : mitred, with cleat angle fixed.

#### SECTION

Casement window 2 leaves - FACTORY SPIRIT® 45°Cut

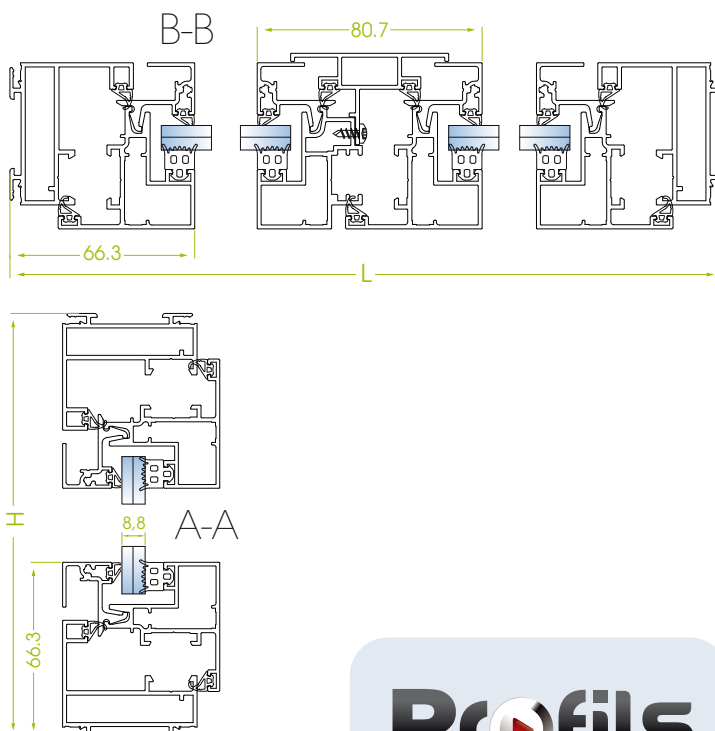

**Profils**  
SYSTEMES

Choose your profile



## SERIES 113

### Traditional aluminium casement window non thermal break

DZAO® is a range of traditional aluminium casement windows without thermal break, allowing large-dimension frames, particularly combined windows in which casement opening, tilt-turn, top or bottom hung etc. can be fitted...



#### CONFIGURATIONS

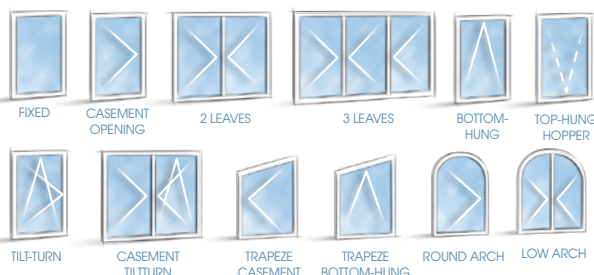

#### FACTORY SPIRIT® VERSION

FACTORY SPIRIT® Design: sleek, spare lines on all opening and fixed sections.

#### FRAME

**Tubular frame** 51mm wide with clip-on weatherdrip and a jamb liner for covering insulation available.

#### OPENING SECTION

**Tubular opening section** : straight edges inside and outside in 55 and 58.4mm.  
Hidden drainage on opening section.

#### FEATURES

- Complete range
- All kinds of **frames** can be created
- Opening section width **55mm** or **58.4mm**
- Effective **water deflector** on fixed frame
- Maximum Dimension up to : **W2200 x H2300mm**
- **Disabled access sill**
- **Hidden drainage** on opening section
- **Arche/traves** and weather-drips common to whole series
- **Invisible hinges**
- Locking rod and handle **without base-plate** available
- **Simplified gaskets** : time saving
- Available in all Profils Systèmes' exclusive colours : **Terra Cigala®, Profils Color®, Terre de Matières®**
- **Colour shades guaranteed up to 25 years**

#### RATINGS

##### Weather tightness :

Dimensions W1400 x H1400mm / Results AEV : **A\*4 E\*8A V\*C5** casement window 2 leaves

Dimensions W1300 x H2200mm / Results AEV : **A\*4 E\*9A V\*A5** casement window 2 leaves

##### Acoustics :

Glazing **38/23** : Ra, tr = **36 dB** | Glazing **4/6/10** : Ra, tr = **35 dB**

#### GLAZING

Single or insulated glazing from 4 to 30mm (50mm with expander) held by 2 EPDM gaskets and 1 clip-on glazing bead minimum height 21mm (base of groove).

#### ASSEMBLY

Fixed frame and opening section : mitred, with cleat angle fixed

#### ACCESSIBILITY

Disabled access sill

#### SECTION

**Casement window 2 leaves**  
**FACTORY SPIRIT® 45°Cut**

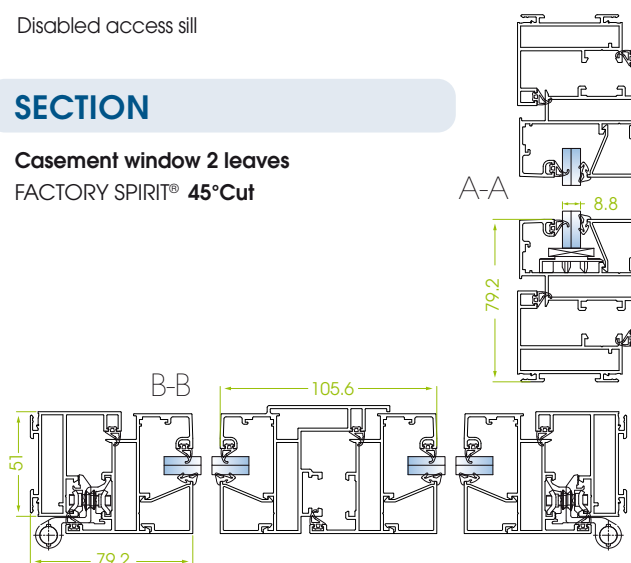

www.profil-systemes.com

Parc Activités Massane - 10 rue Alfred Sauvy  
34 670 Baillargues - France / Tél : +33 4 67 87 67 87  
A Corialis affiliated company



This guarantee is only available to professional retailers who are clients of Profils Systèmes, see terms and conditions of sale at [www.profil-systemes.com](http://www.profil-systemes.com) \*Certificat n°002-529